

**Property and buffer zone  
Planetarium Eise Eisinga  
(Eise Eisinga Planetarium)  
in  
Franeker**

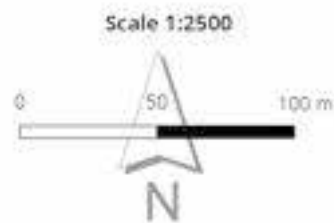

**Legend**

-  World Heritage property
-  World Heritage buffer zone
-  cadastral border
-  coordinate grid Rijkdriehoekstelsel (Netherlands National System)
-  coordinate grid WGS 84 UTM Zone 31N



Topographical background:  
J.W. van Aarts, [www.opentopoonl.nl](http://www.opentopoonl.nl)

7. Nominated property with buffer zone. Cultural Heritage Agency of the Netherlands.



Property Planetarium Eise Eisinga  
(Eise Eisinga Planetarium)  
in  
Franeker



- Legend**
- World Heritage property
  - State Monument (15669)
  - building or construction
  - cadastral border
  - coordinate grid Rijksdriehoekstelsel (Netherlands National System)
  - coordinate grid WGS 84 UTM Zone 31N

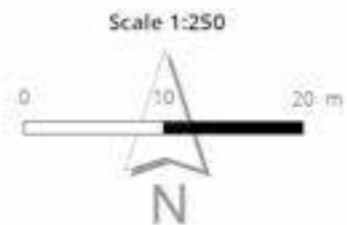

Topographical background:  
(W. van Aals, www.opentopo.nl)

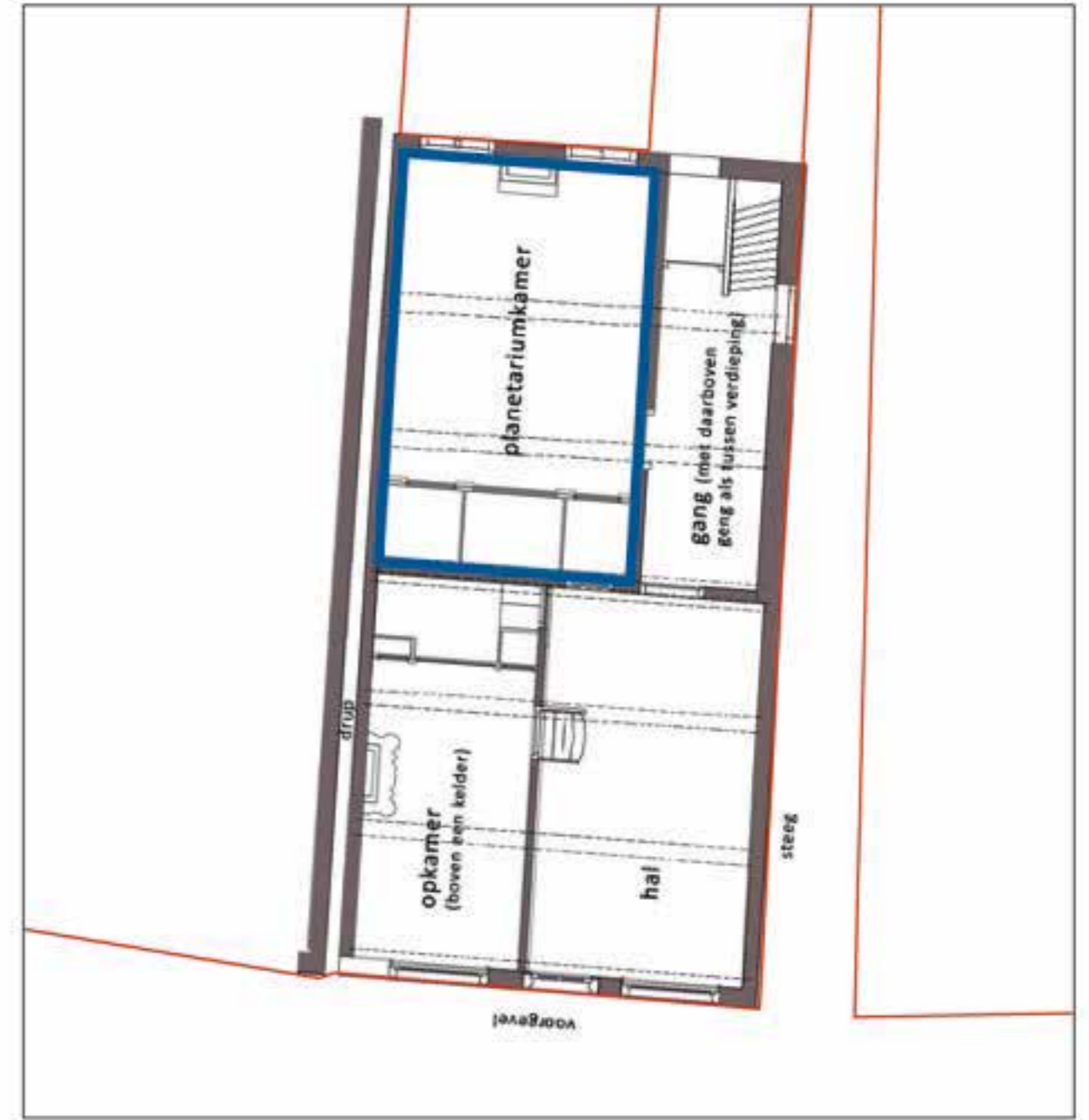

Property Planetarium Eise Eisinga  
(Eise Eisinga Planetarium)  
and building plan  
in  
Franeker



- Legend**
- World Heritage property
  - building or construction

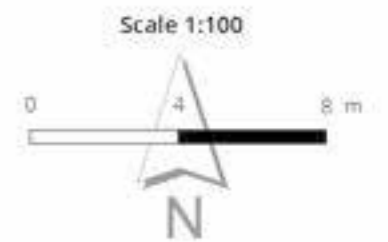

8. Map of the area of the nominated property.

9. Map of the nominated property. Cultural Heritage Agency of the Netherlands.

**Planetarium Eise Eisinga  
within Franeker and The Netherlands**

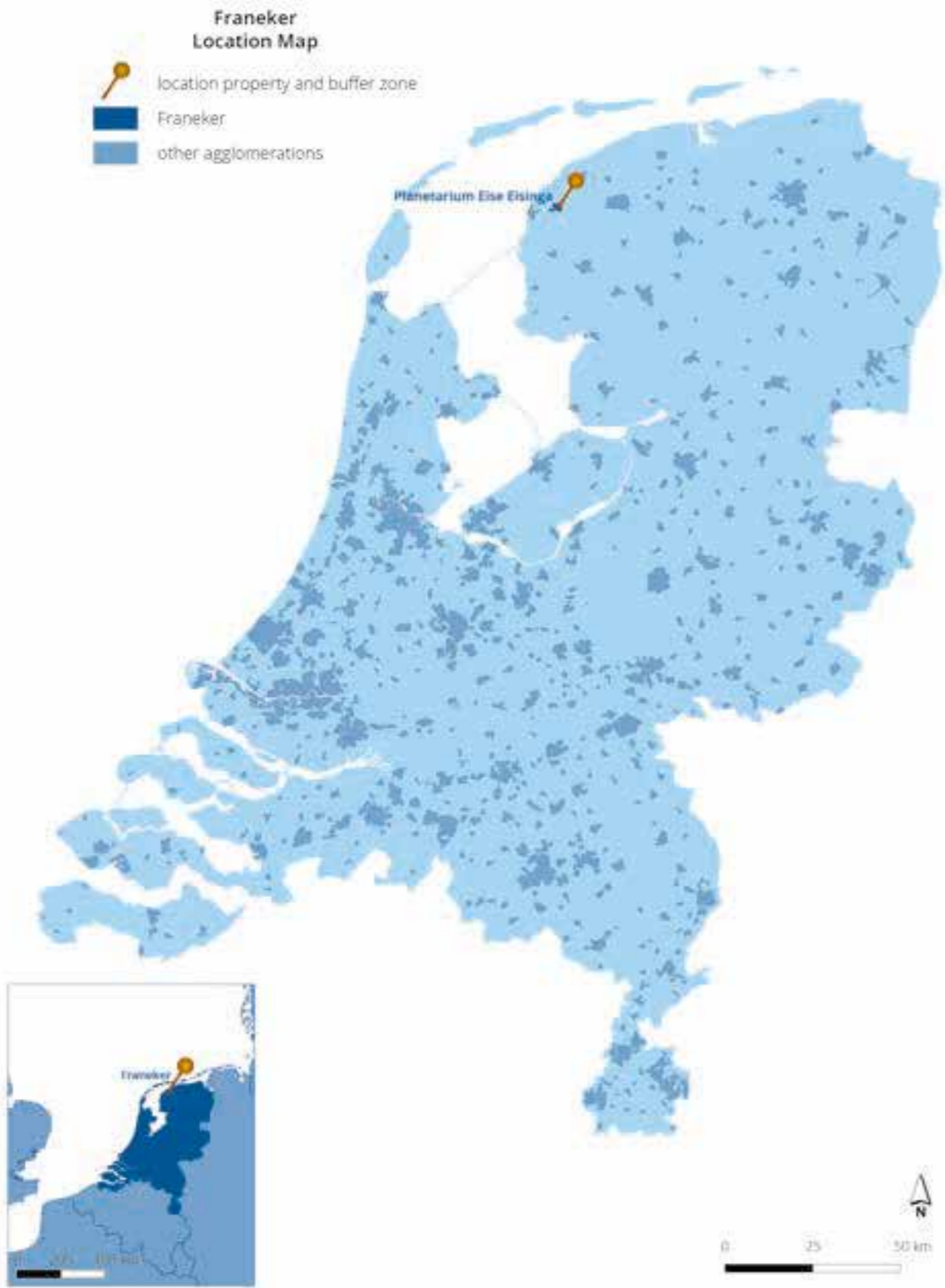

12. Map showing the Netherlands with the city of Franeker.



13. Map showing the municipality of Waadhoeke and the city of Franeker.

### List of maps showing the property

5. Fold-out map 1, planetarium instrument. Edition Royal Eise Eisinga Planetarium **[Executive summary]**
6. Fold-out map 2, cogwheels. Edition Royal Eise Eisinga Planetarium **[Executive summary]**.
7. Nominated property with buffer zone. Cultural Heritage Agency of the Netherlands **[Executive summary]**.
8. Map of the area of the nominated property **[Executive summary]**.
9. Map of the nominated property. Cultural Heritage Agency of the Netherlands **[Executive summary]**.
11. Map showing Europe with the Netherlands **[Section 1.e]**.
12. Map showing the Netherlands with the city of Franeker **[Section 1.e]**.
13. Map showing the municipality of Waadhoeke and the city of Franeker **[Section 1.e]**.
14. Area of the nominated property, cadastral map. Cadastral designation (Planetarium, Eise Eisingastraat 3): Municipality of Franeker, Section A, Number 3320 **[Section 1.f]**.
15. Location of the nominated property in Franeker **[Section 1.f]**.
16. Area of the nominated property **[Section 1.f]**.
17. Area of the nominated property **[Section 1.f]**.
120. Cadastral floor plan Eise Eisingastraat 1, 2 and 3 **[Section 5.a]**.
121. Buffer zone. Municipality of Waadhoeke **[Section 5.b]**.
122. Map protected cityscape of Franeker, relating to the Designation Decree by the State Secretary for Culture, Recreation and Social Work and the Minister of Public Housing and Spatial Planning, 21 February 1979 **[Section 5.b]**.
123. Planetarium, buffer zone (within blue outline) and protected cityscape (within red outline) **[Section 5.b]**.
124. Planetarium, buffer zone (within purple outline) and protected cityscape (within blue outline) **[Section 5.b]**.
125. Planetarium and buffer zone (within purple outline) **[Section 5.b]**.
126. Property within the buffer zone **[Section 5.b]**.
127. Franeker, parking space and rates. Source: Municipality of Waadhoeke, 2021 **[Section 5.c]**.
153. Planetarium, exhibition/floor plan. Edition Royal Eise Eisinga Planetarium **[Section 5.h]**.

### 1.F MAPS SHOWING THE AREA OF THE PROPERTY

Area of nominated property:	Area of buffer zone:	Total area:
0.00271 hectare	2.12539 hectares	2.12810 hectares

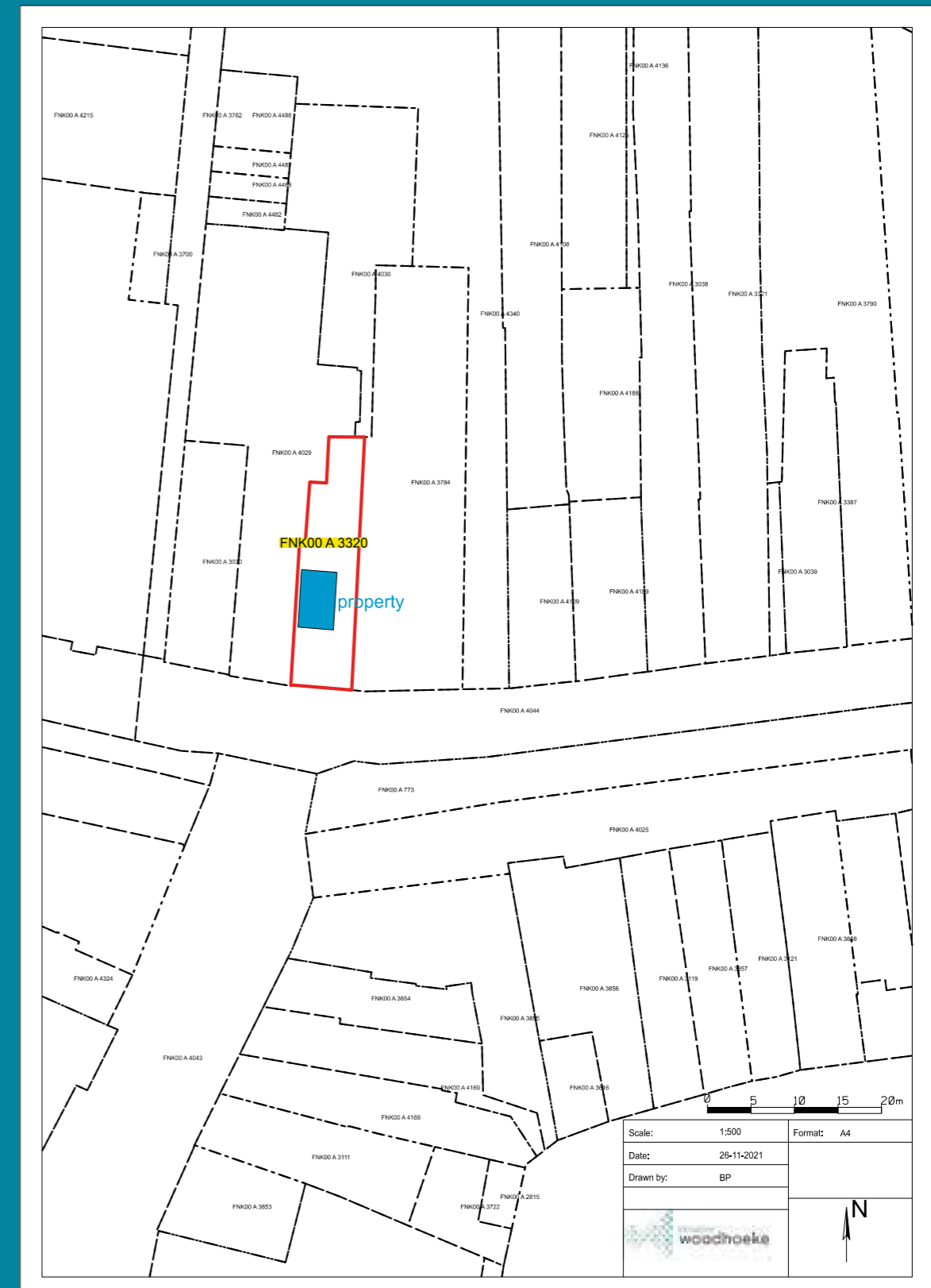

14. Area of the nominated property, cadastral map. Cadastral designation [Planetarium, Eise Eisingastraat 3]: Municipality of Franeker, Section A, Number 3320.



15. Location of the nominated property in Franeke. Buffer zone (within purple outline) and protected cityscape (within blue outline).



16. Area of the nominated property. Buffer zone (within purple outline).







17. Location of the nominated property.



**Property Eisinga Planetarium  
in  
Franeker**



- Legend**
-  World Heritage property
  -  State Monument (15669)
  -  building or construction
  -  cadastral border
  -  coordinate grid Rijksdriehoekstelsel (Netherlands National System)
  -  coordinate grid WGS 84 UTM Zone 31N

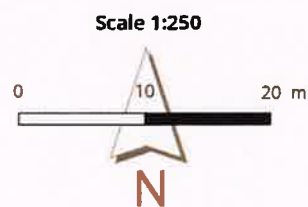

Topographical background:  
J.W. van Aalst, [www.opentopo.nl](http://www.opentopo.nl)

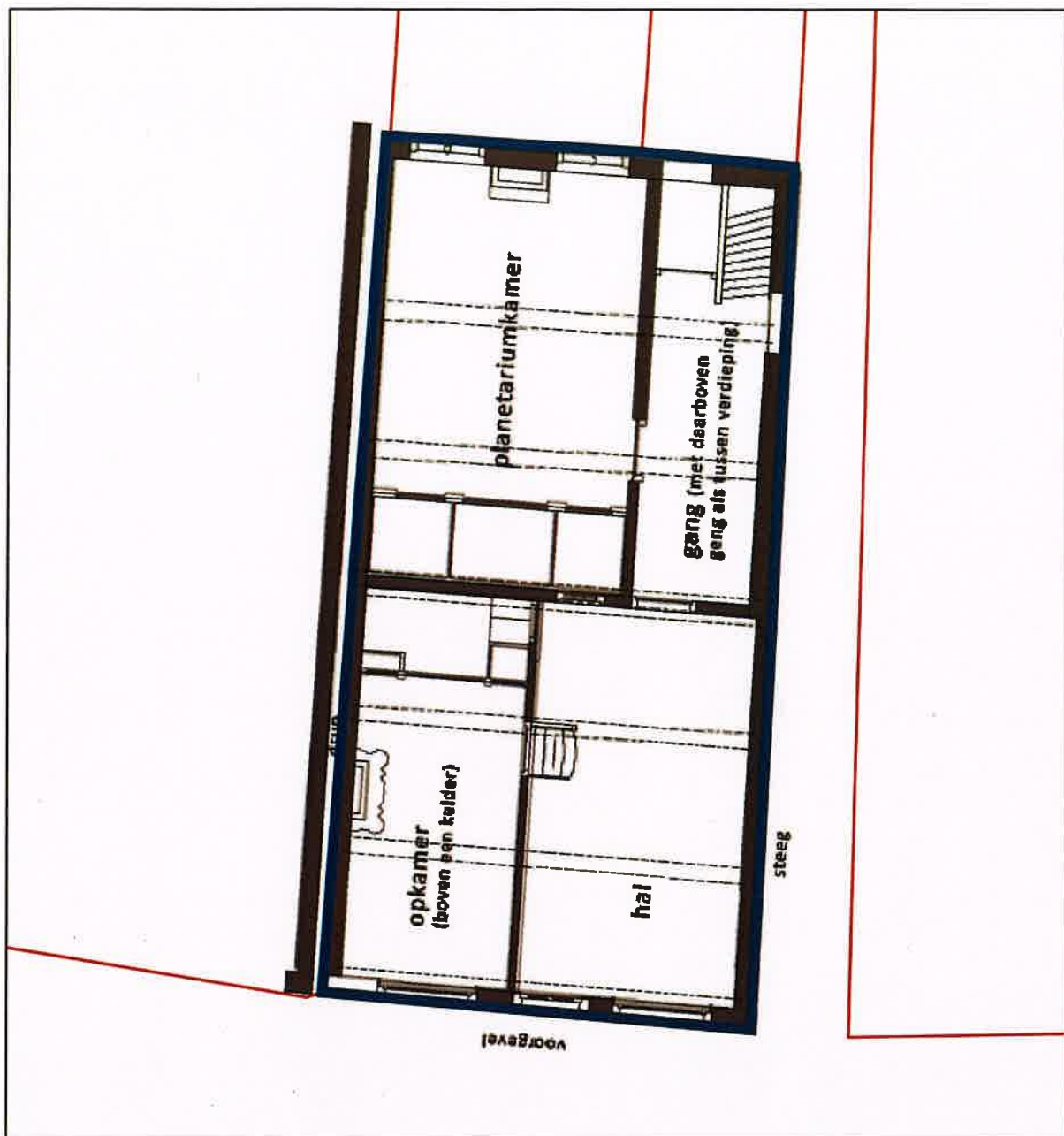



**Property Eisinga Planetarium  
and building plan  
in  
Franeker**

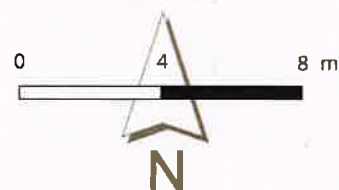

Scale 1:100





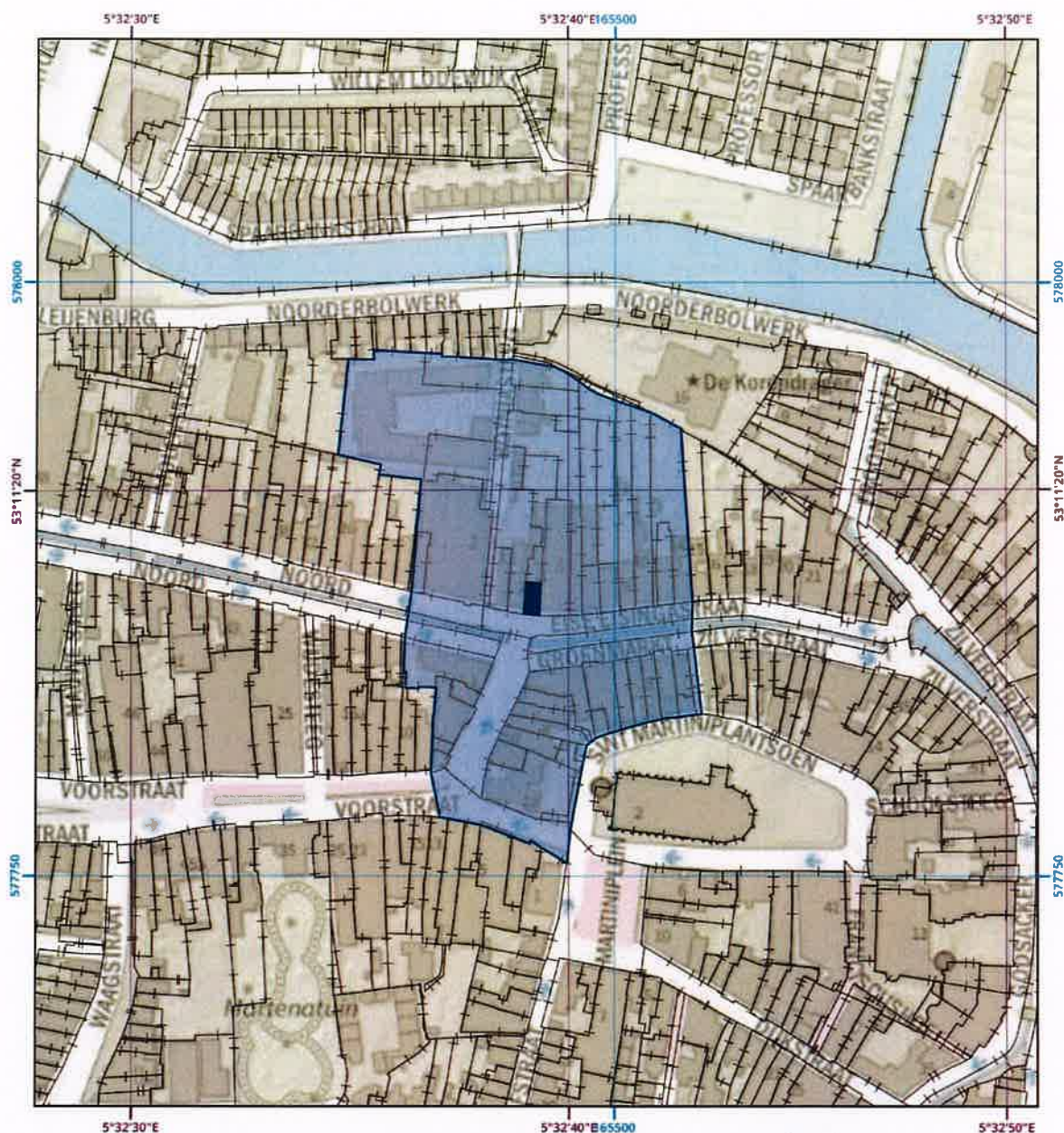

**Legend**

-  World Heritage property
-  building or construction



**Property and buffer zone  
Eisinga Planetarium  
in  
Franeker**

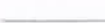

-  World Heritage property
-  World Heritage buffer zone
-  cadastral border
-  coordinate grid Rijksdriehoekstelsel (Netherlands National System)
-  coordinate grid WGS 84 UTM Zone 31N

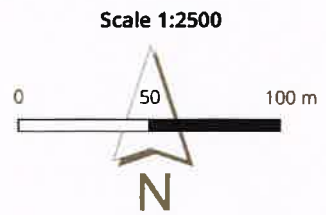

Topographical background:  
J.W. van Aalst, [www.opentopo.nl](http://www.opentopo.nl)