



# United States Department of the Interior

## NATIONAL PARK SERVICE

1849 C Street, N.W.  
Washington, DC 20240

NOV 12 2015

Mechtild Rössler  
Director  
World Heritage Centre  
UNESCO  
7, Place de Fontenoy  
75352 Paris 07 SP, France

Dear Ms. Rössler:

This is a clarification of the boundary of the World Heritage property “**Cahokia Mounds State Historic Site**” in response to the Retrospective Inventory, as well as a request for a minor boundary modification to formalize this clarification.

In compliance with the requirements of the *Operational Guidelines*, namely paragraph 164 and Annex 11, we are providing the following information to propose the minor boundary modification:

**1) Area of the property (in hectares):**

- a) The area of the property presented at the time of inscription was 591 hectares, which as noted in the previous Periodic Report, was a typographical error.
- b) The corrected number of hectares for the property is 541. (This is unaffected by the clarifications provided below, as the areas in question were never included in the area calculations.)

**2) Description of the modification:**

The modification requested is in the nature of a correction, rather than a substantive change, to the boundaries presented with the original nomination. At this time we are not proposing to expand the boundary to include the additional land acquired since the time of inscription by the State of Illinois.

- The corrected map no longer includes a small triangular section at the southeast corner of the property (#1 on the overlay comparison map).
- The corrected map now includes a small sliver of land along the eastern boundary of the property (#2 on the overlay comparison map).

**3) Justification for the modification:**

This modification corrects two cartographic errors on the map submitted with the original nomination:

1. The June 30, 1981 map submitted with the nomination had an error drawn in the boundary in the southeast part of the property. The land that was acquired by the State of Illinois for the Cahokia Mounds State Historic Site in 1979 follows the northeast / southwest line of the Harding Ditch towards Black Lane, instead of extending straight east to Black Lane and then following it to the north.



2. This is the location of the access road for the large (134.6 acre) tract of land immediately south of the discrepancy location. The lot containing the access road has a different parcel identification number than the larger tract to the south. The small lot (0.15 acre) apparently was left off the original map because it had a different parcel identification number.

**4) Contribution to the maintenance of the Outstanding Universal Value:**

The modifications requested are in the nature of a correction. They are small in size and located at the periphery of the boundary. The proposed corrections to the map do not affect the structures and features that contribute to the property's Outstanding Universal Value and which were described in the nomination.

**5) Implications for legal protection:**

The correction to the boundary will make no change to the legal protection of the property.

**6) Implications for management arrangements:**

The correction to the boundary will make no change to the management of the property.

**7) Maps:**

Three maps are attached:

- A newly created map of the boundary as it was included with the original nomination (in response to the Retrospective Inventory);
- A map containing a the proposed minor boundary modification;
- A map with an overlay of the two boundaries.

Sincerely,

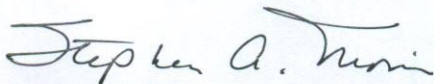

Stephen A. Morris  
Chief, Office of International Affairs

cc: Ambassador Crystal Nix-Hines, U.S. Permanent Representative to UNESCO

**Attachments:**

- A map of the boundary proposed with the original nomination (in response to the Retrospective Inventory)
- A map containing the proposed minor boundary modification
- A map with an overlay of the two boundaries



# Cahokia Mounds State Historic Site

Original Nomination World Heritage Boundary Map as Inscribed in 1982

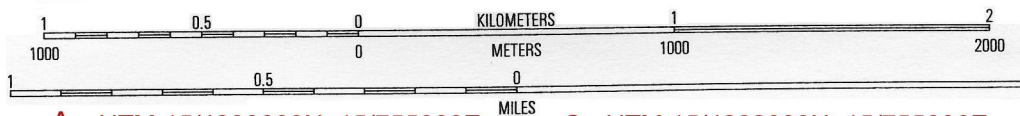
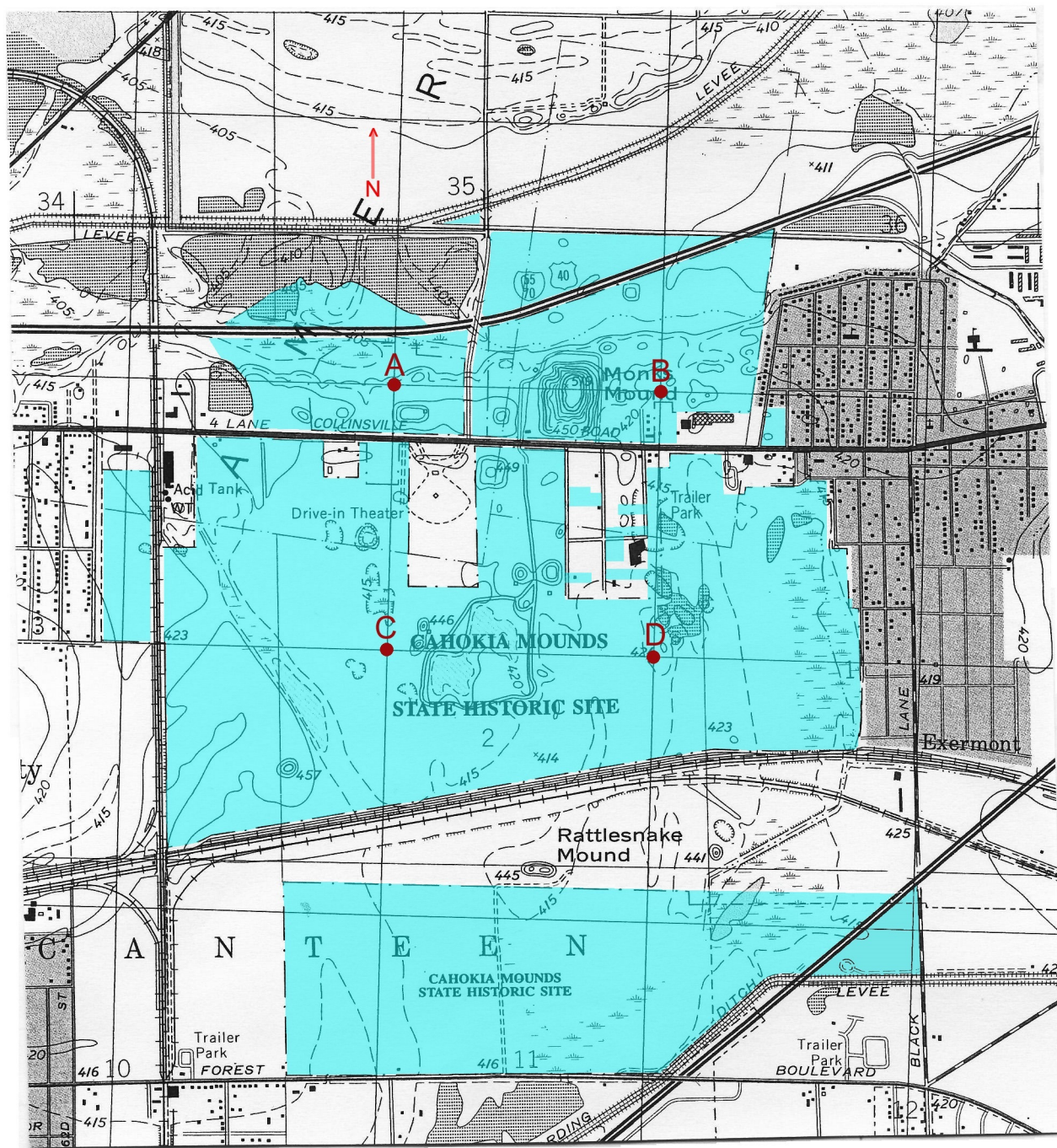

A - UTM 15/4283000N, 15/755000E

B - UTM 15/4283000N, 15/756000E

C - UTM 15/4282000N, 15/755000E

D - UTM 15/4282000N, 15/756000E



# Cahokia Mounds State Historic Site

Original Nomination World Heritage Boundary Map as Inscribed in 1982

(541 hectares)

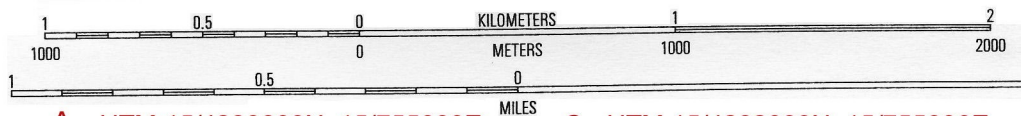
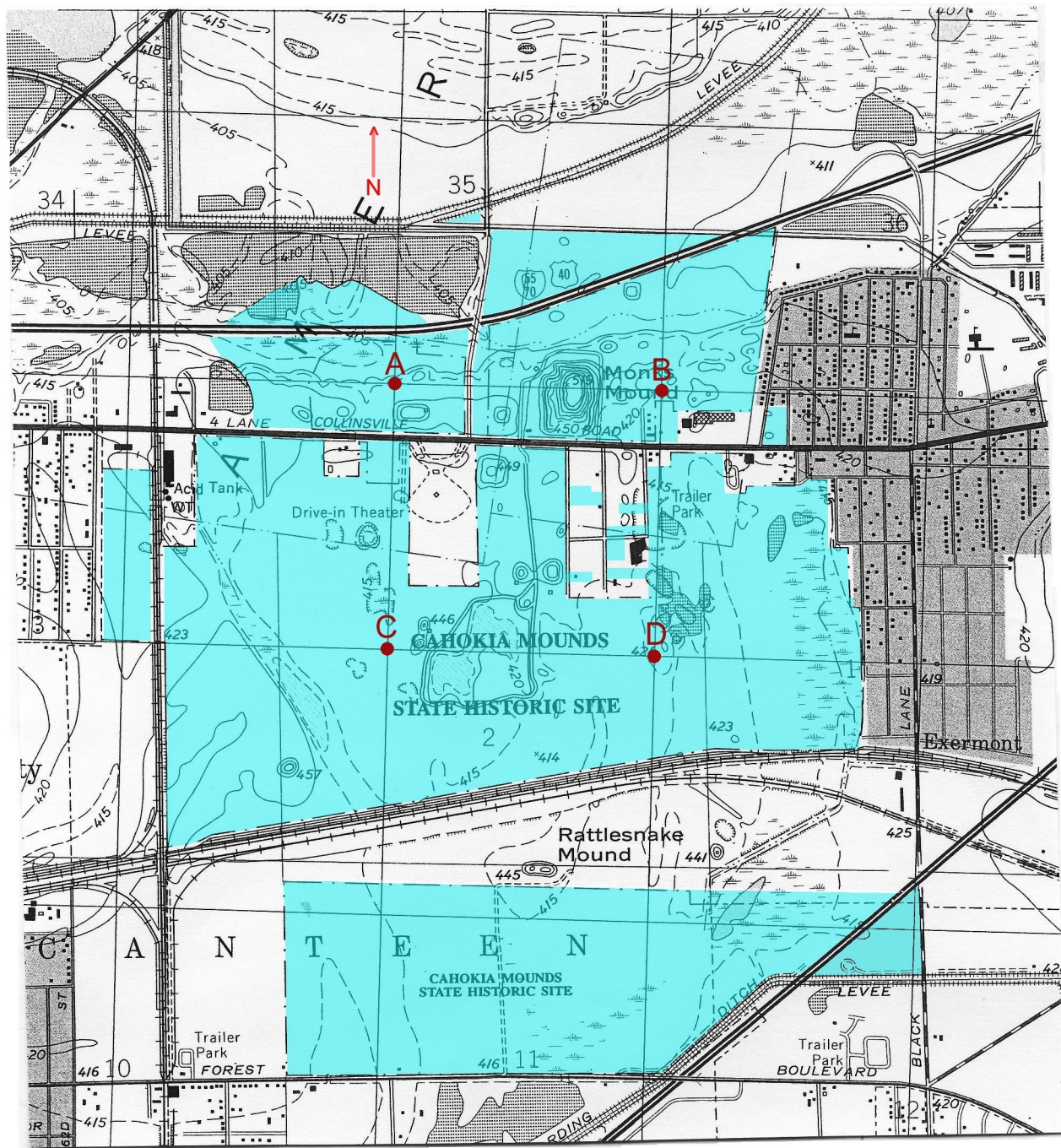

A - UTM 15/4283000N, 15/755000E

B - UTM 15/4283000N, 15/756000E

C - UTM 15/4282000N, 15/755000E

D - UTM 15/4282000N, 15/756000E



# Cahokia Mounds State Historic Site

World Heritage Boundaries - Identified Locations of discrepancies

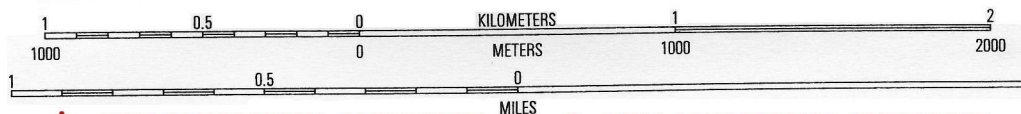
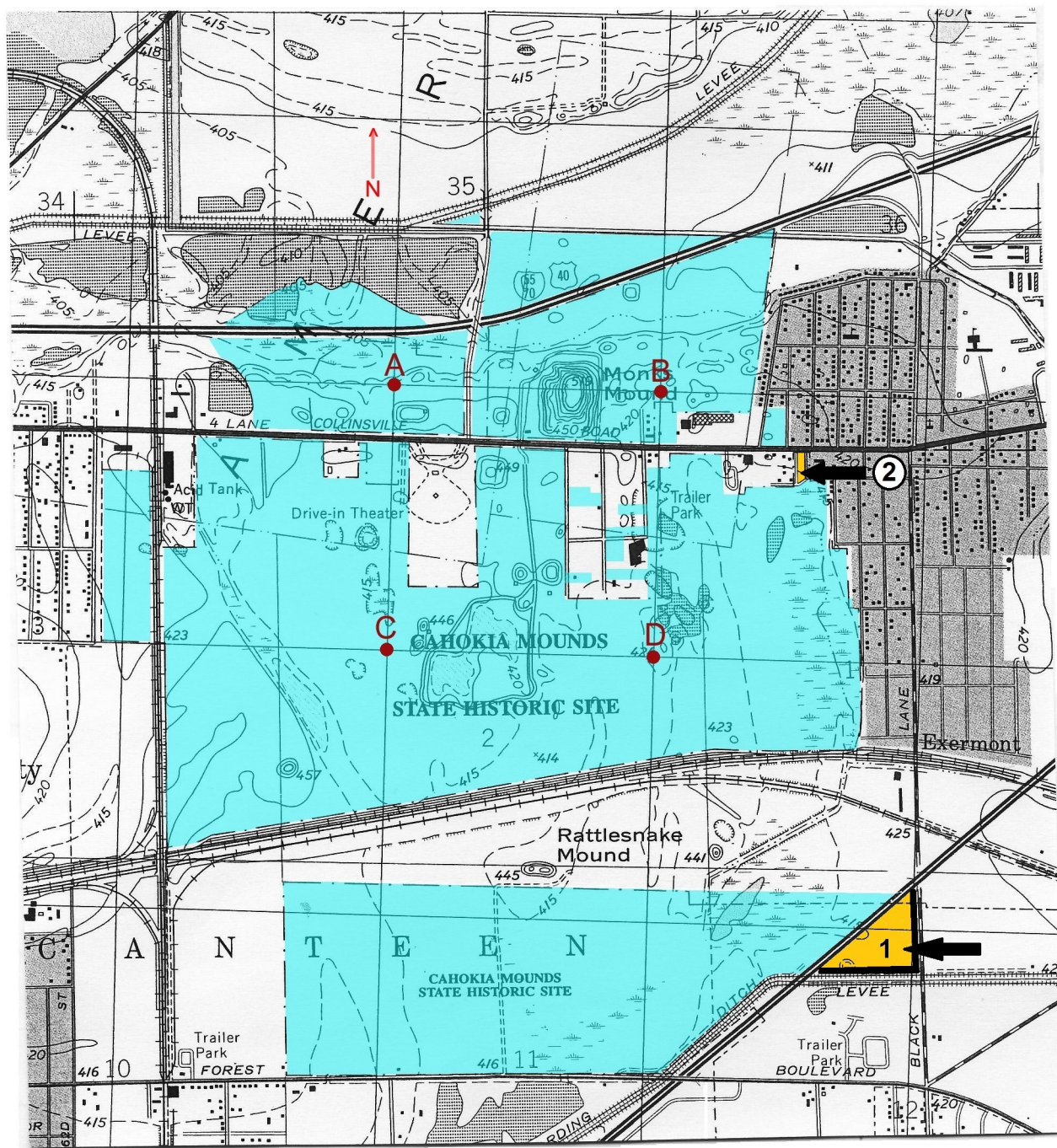

A - UTM 15/4283000N, 15/755000E

B - UTM 15/4283000N, 15/756000E

C - UTM 15/4282000N, 15/755000E

D - UTM 15/4282000N, 15/756000E