

A2

A1

Zwischenbach

Strecke 18

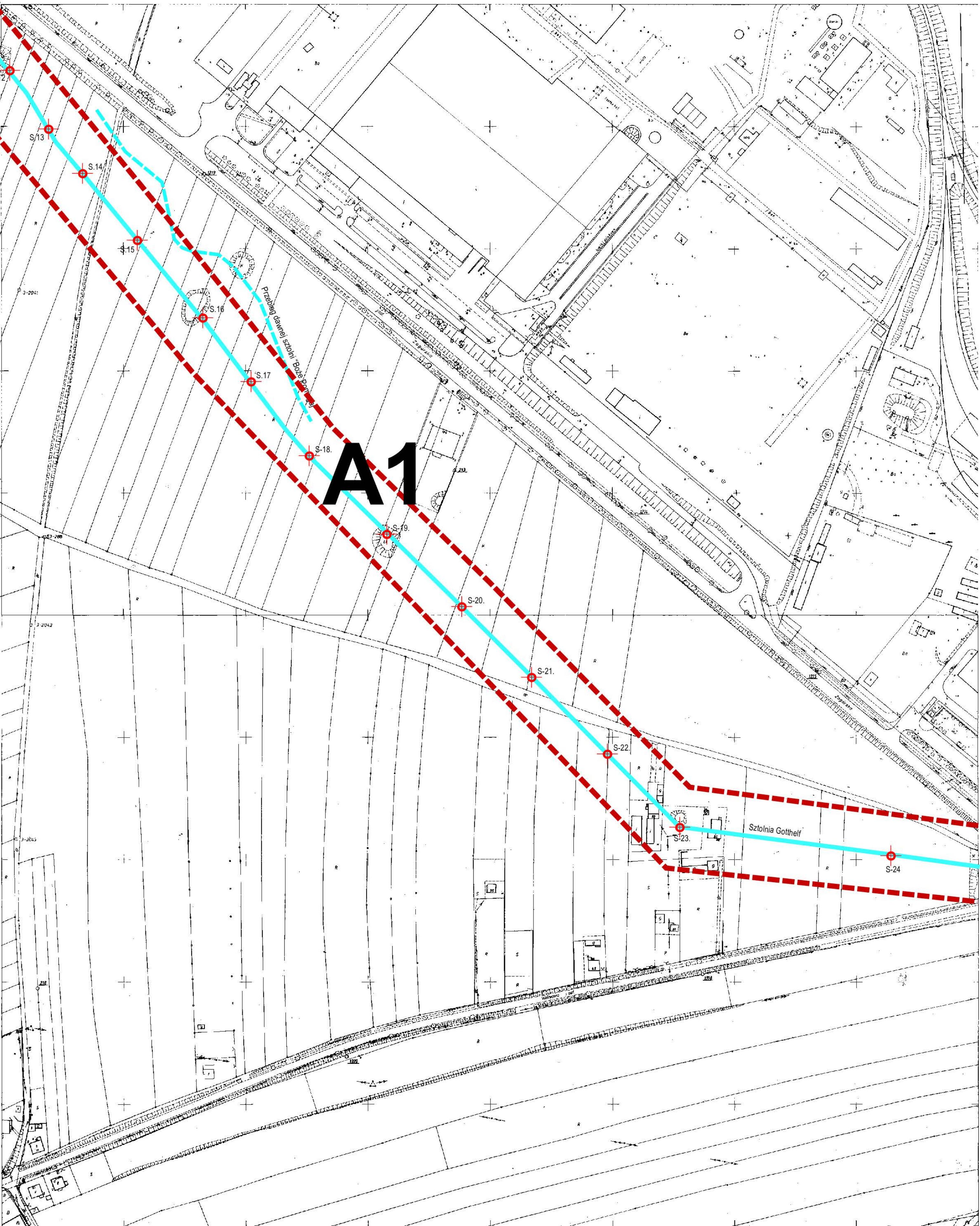
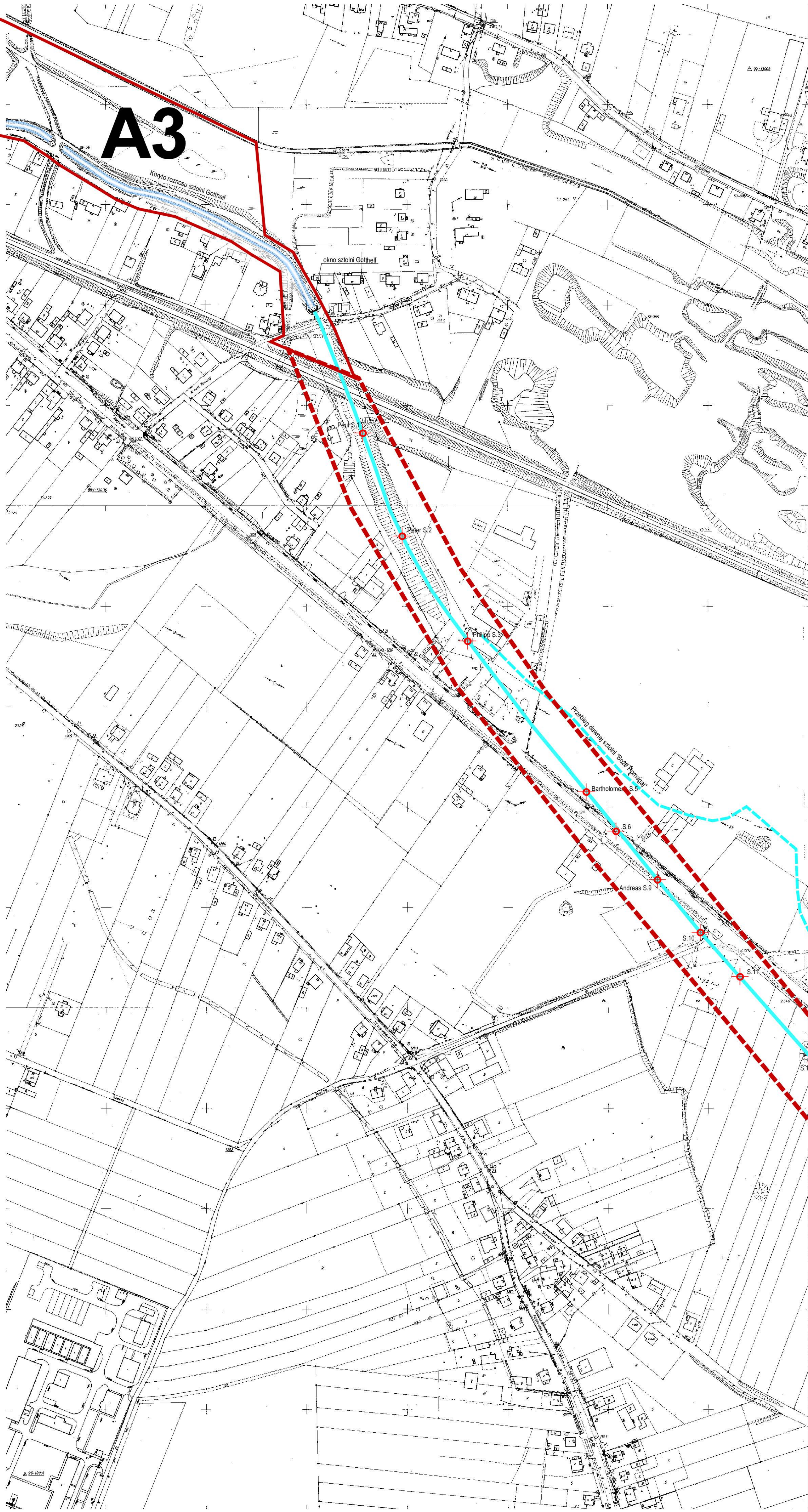

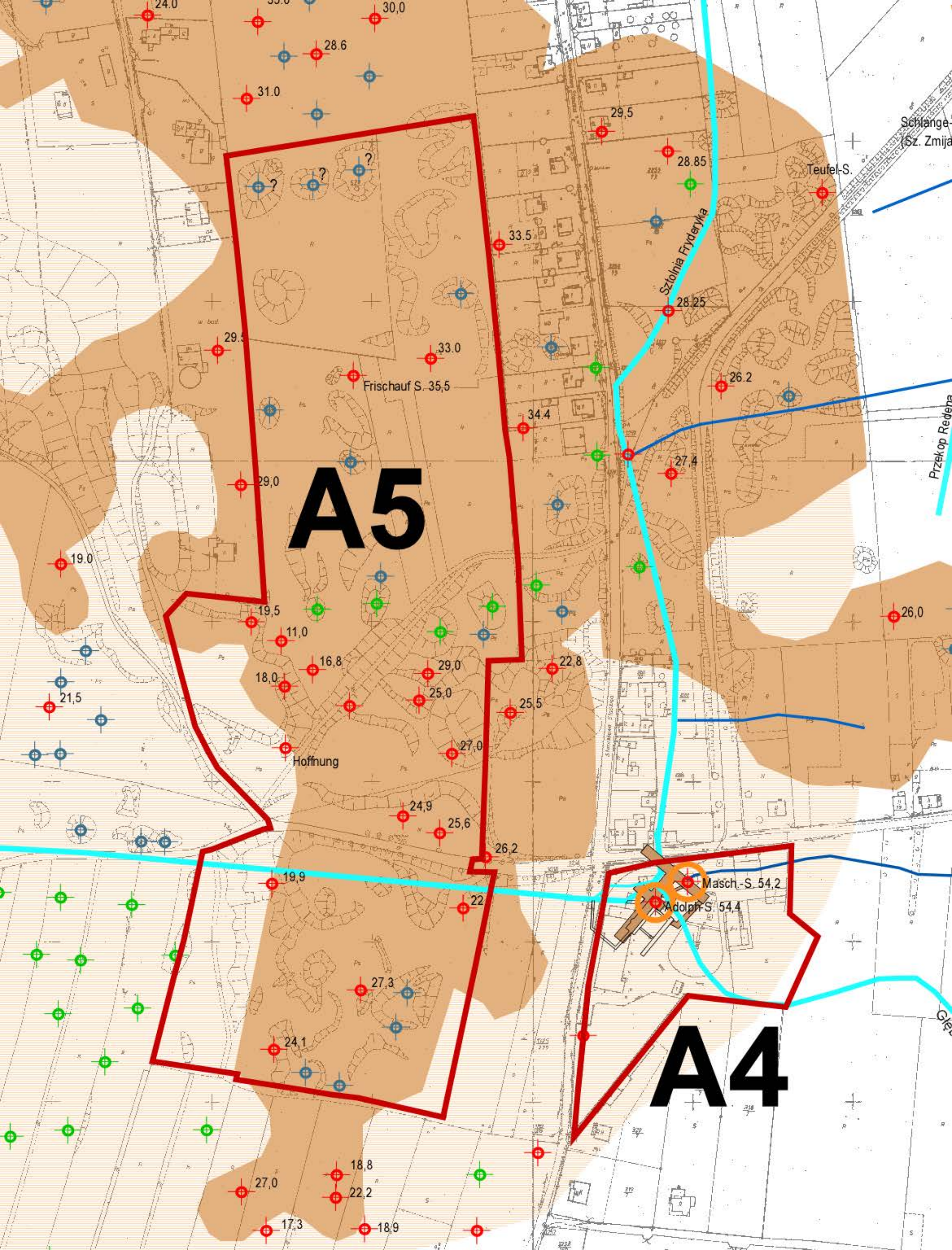

A5

A4

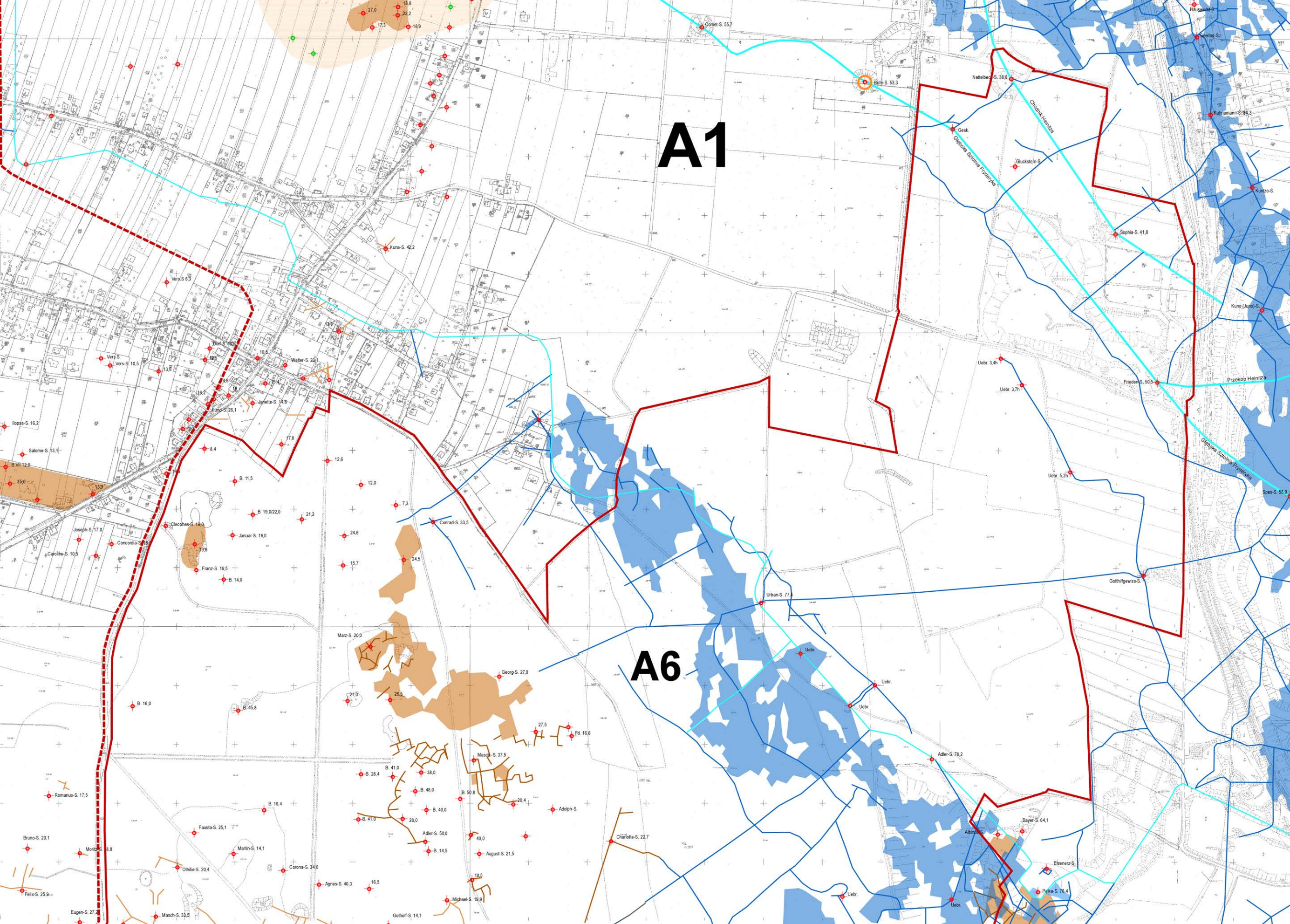

A1

A6

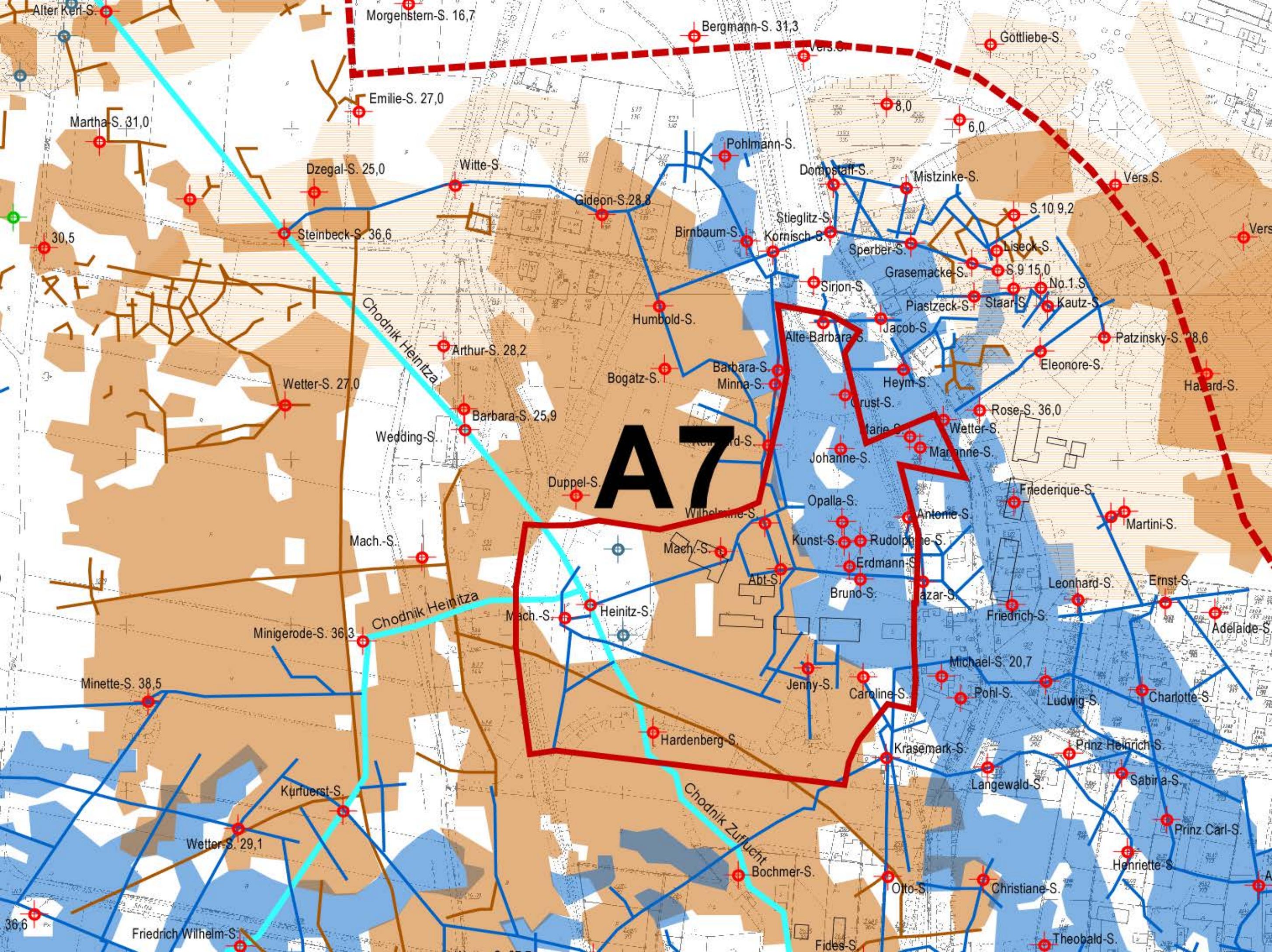

A8

Map showing the A8 area in Reda, with various points of interest labeled with names and numbers. The map includes a red dashed line, a red solid line, and a blue line. The area is shaded in brown and orange. The map is titled 'A8' in large black letters.

Points of interest labeled on the map include:

- Fortuna-S. 51.6
- Wetter-S.
- Lorentz-S. 48.7
- Grun-S. 42.8
- Lang-S. 47.5
- Langer-S. 45.6
- Wasserhlt-S. 48.05
- Barluset-S.
- Florian-S. 40.0
- Brunnen-S. 37.6
- Johann-S. 39.0
- Kapuscinski-S. 31.0
- 33.6
- 33.8
- 36.5
- Gsk 9.5
- lonas-S.
- 24" Mach-S.
- Aurora-S. 49.9
- Grenz-S. 35.6
- Stephan-S.
- Iris-S.
- 41.0
- S.III 35.0
- Marie-S. 30.5
- Enoch-S. 30.0
- Clara-S.II. 10.0
- Clara-S.I. 10.0
- Alter S. 30.0
- 28.7
- 29.3
- 31.5
- 36.3
- 39.0
- 43.2
- 44.6
- 45.0
- 40.8
- 48.7
- 40.2
- 39.0

Other labels include: Przekop Redena, Redena, and various street names like 'Kardynała S. Myszolubskiego'.